

Übersichtsplan Elektro-/EDV- Anlage MS Linth

2. Oberdeck

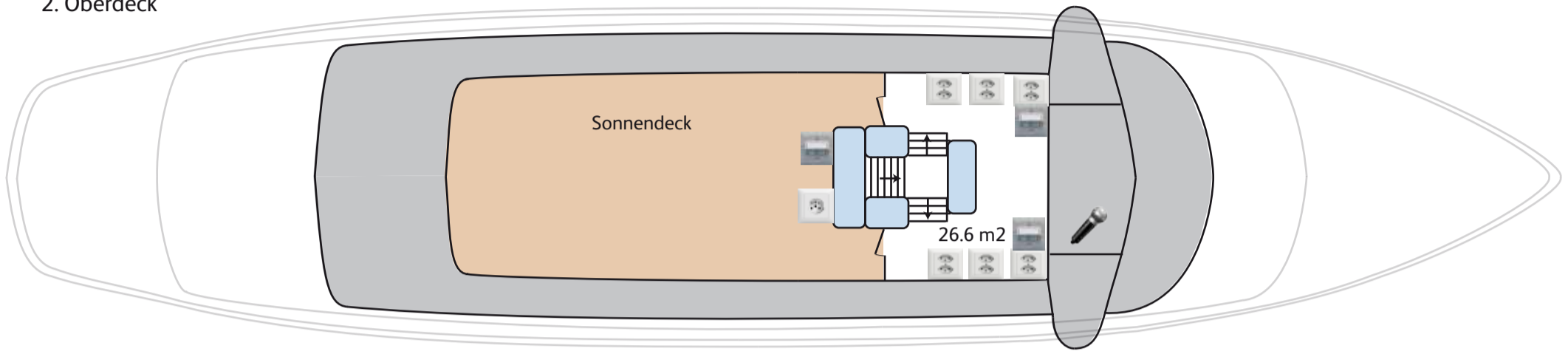

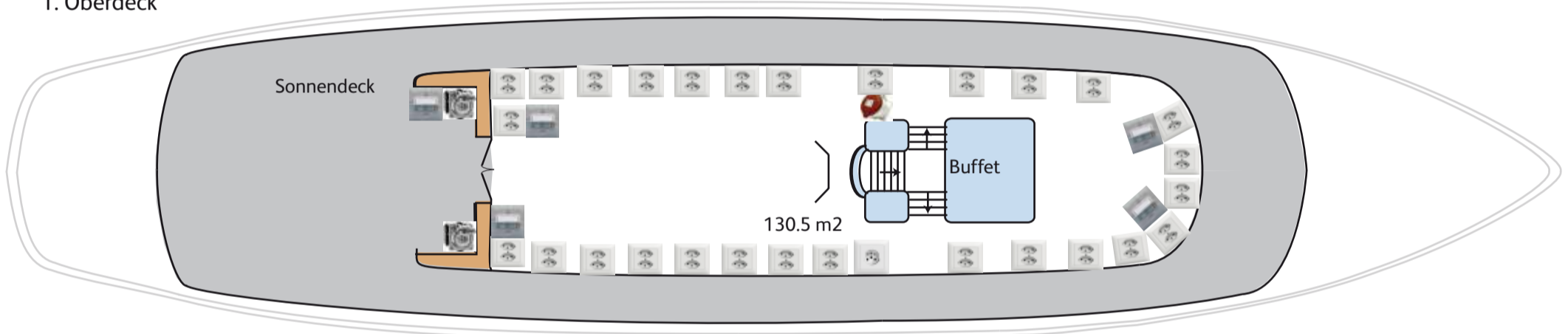



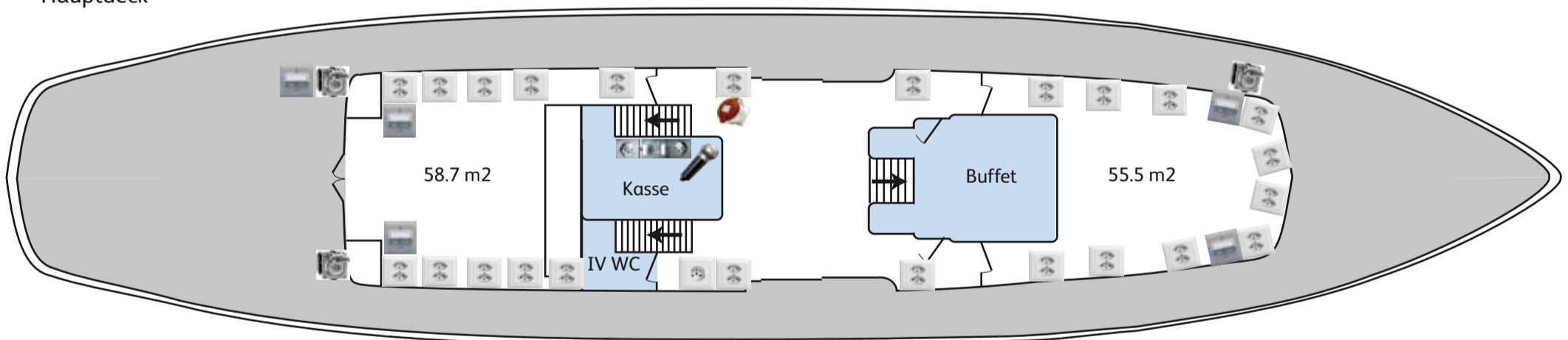

1. Oberdeck



Hauptdeck



-  Steckdose CE 32 A (400 V)
-  Steckdose 2 x T13 (230 V)
-  Steckdose T 25 (230/400 V)
-  Steckdose T13 (aussen) (230 V)

-  Mikrofon
-  Netzwerkanschluss RJ 45
-  Chinch, Klinkenanschluss Kasse